

# Ground Floor, Main Hotel

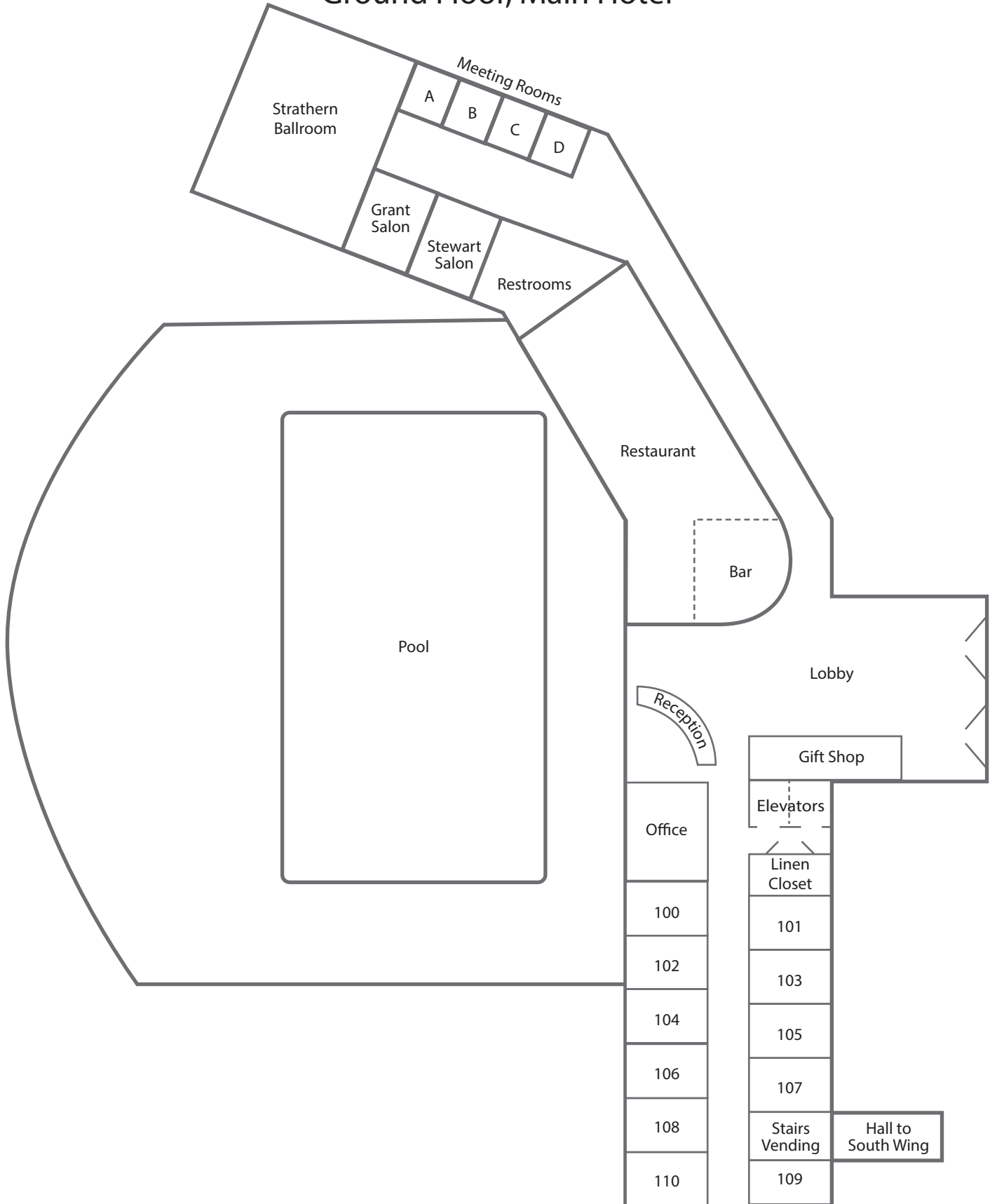

# Ground Floor, South Wing All Suites

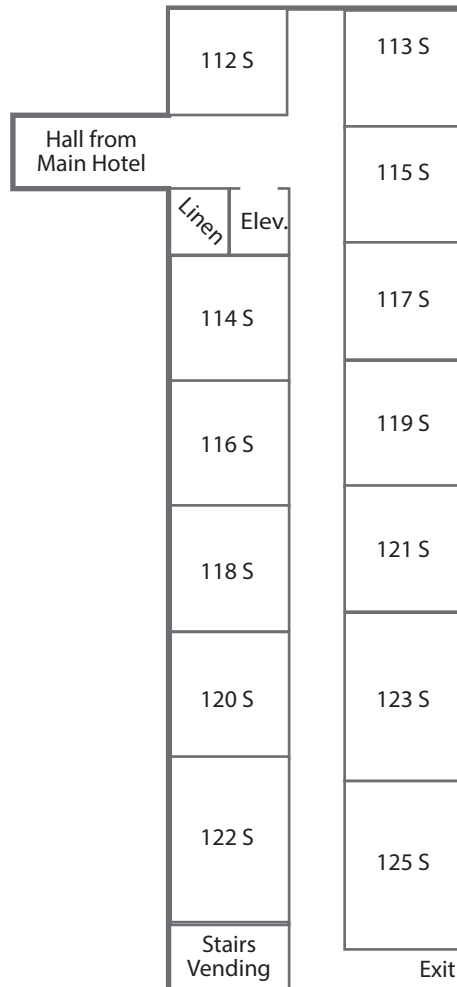

Note: there is no room 124. Perhaps this could be an inside joke with hotel staff? When a customer is difficult, they could talk about putting him or her in Room 124?

## Second Floor, Main Hotel

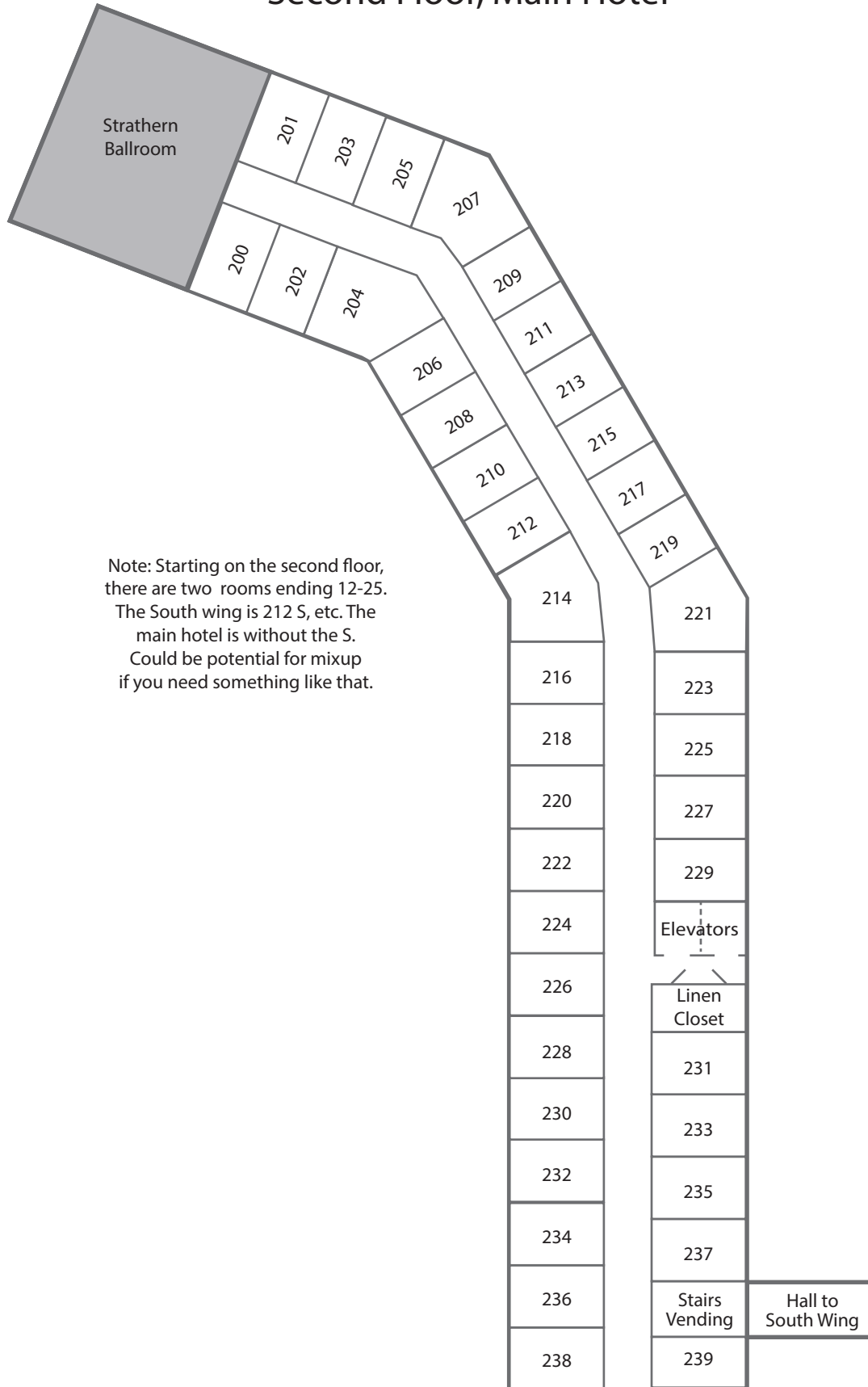

Note: Starting on the second floor, there are two rooms ending 12-25. The South wing is 212 S, etc. The main hotel is without the S. Could be potential for mixup if you need something like that.

# Second Floor, South Wing All Suites

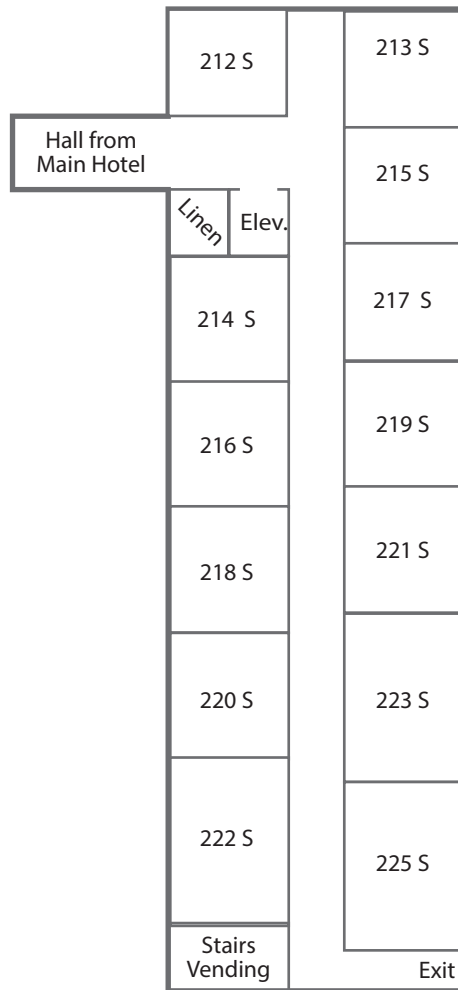

# Third Floor, Main Hotel

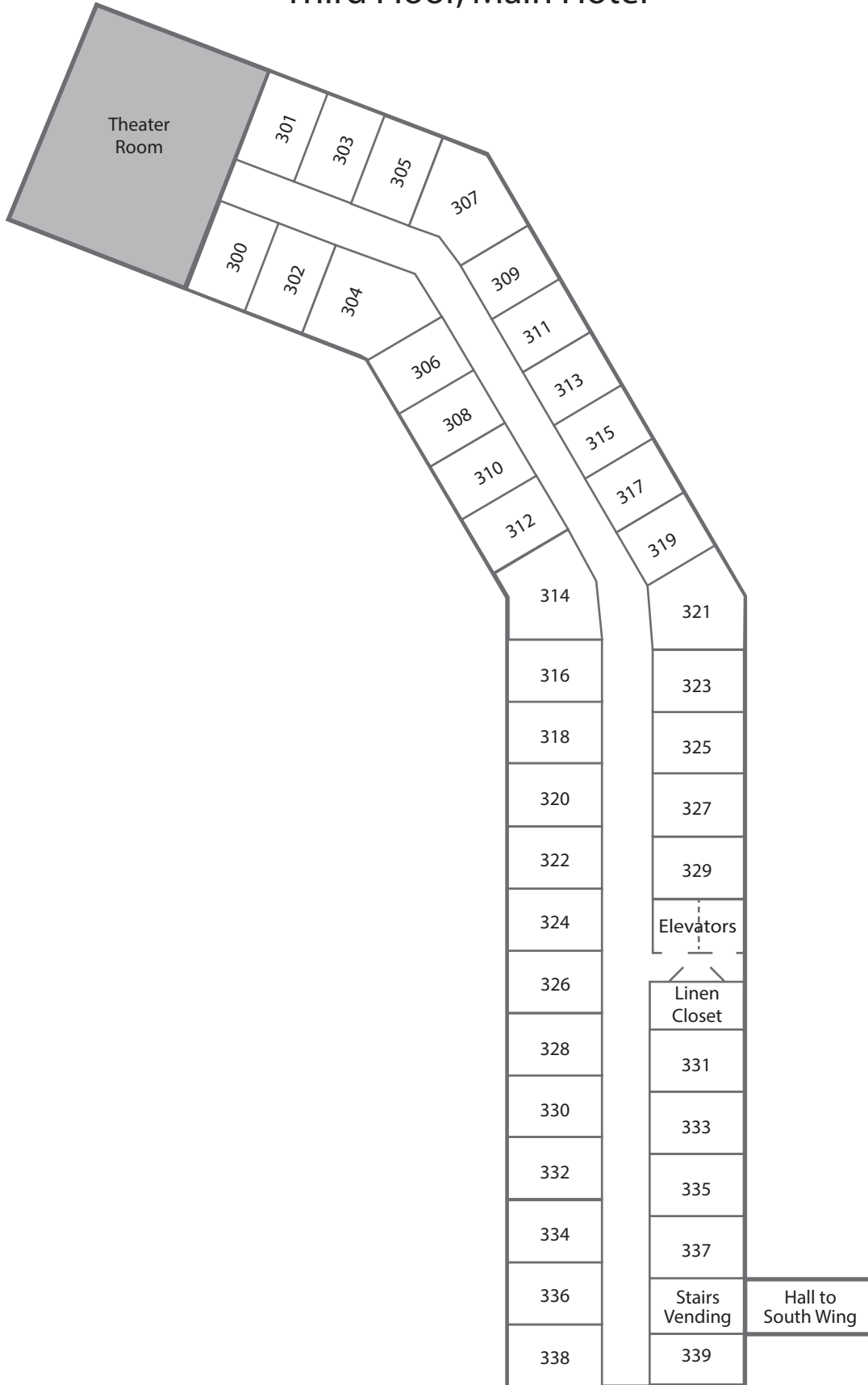

# Third Floor, South Wing All Suites

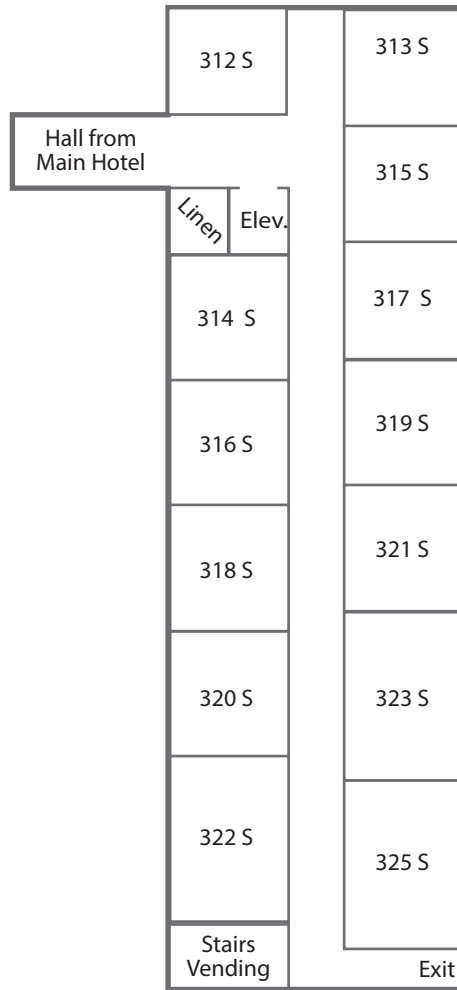

# Fourth Floor, Main Hotel

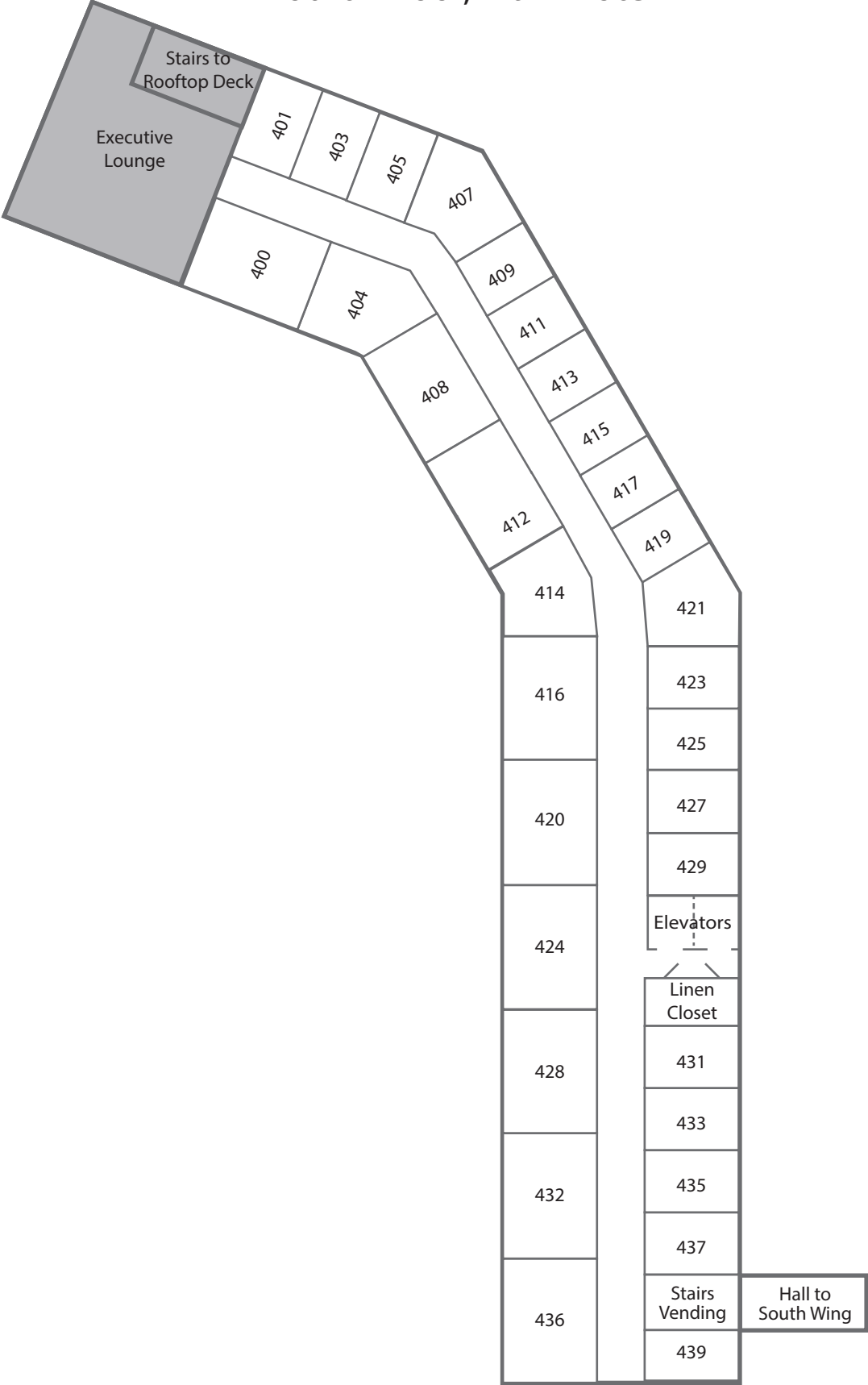

# Fourth Floor, South Wing All Suites

